

SITE DATA:
TOTAL ACRES - 5.6
TRACT 'A' - 3.4
TRACT 'B' - 2.2
LAND LOT 596
1st DISTRICT, 2nd SECTION

- TREE ORDINANCE NOTIFICATION BY RESIDENT:**
- THE ARBORIST SHALL MAKE UNSCHEDULED INSPECTIONS BEFORE AND DURING DEVELOPMENT TO ENSURE PROTECTION OF TREE CRITICAL ROOT ZONES AND BUFFER ZONES.
 - NO PERSON IN THE CONSTRUCTION OF ANY STRUCTURES OR IMPROVEMENTS OR ANY ACTIVITY SHALL ENCROACH OR PLACE SUBSTANTIAL MATERIAL CONSTRUCTION MATERIALS OR TEMPORARY SOIL DEPOSITS WITHIN SIX (6) FEET OF THE AREA OUTSIDE THE DRIP LINE, AS DEFINED HEREIN, OF ANY SPECIMEN TREE OR ANY TREE WITHIN A TREE PROTECTION ZONE.
 - BEFORE DEVELOPMENT, LAND CLEARING, FILLING, OR ANY LAND ALTERATION, THE OWNER SHALL BE REQUIRED TO ERECT STABLE BARRIERS AS REQUIRED BY THE ARBORIST, INCLUDING TREE FENCES, TREE PROTECTION SIGNS, AND EROSION BARRIERS UNTIL COMPLETION OF SITE LANDSCAPING. AUTHORIZATION TO REMOVE THE PROTECTIVE DEVICES SHALL BE IN WRITING BY THE ARBORIST OR BY THE ISSUANCE OF A FINAL CERTIFICATE OF OCCUPANCY. INSPECTION OF TREE PROTECTION BARRIERS IS REQUIRED PRIOR TO ANY LAND IMPROVEMENT OR DEVELOPMENT. THE ARBORIST SHALL BE CONTACTED TO SCHEDULE AN INSPECTION TIME.
 - MATERIALS FOR ACTIVE TREE PROTECTION SHALL CONSIST OF CHAIN LINK OR ANGE LAMINATED PLASTIC, WOODEN POST AND RAIL FENCING OR OTHER EQUIVALENT RESTRAINING MATERIAL. IN ADDITION TO FENCING, WHERE ACTIVE TREE PROTECTION IS REQUIRED EACH TREE TO BE SAVED SHALL BE MARKED AT THE BASE OF THE TRUNK WITH BLUE COLORED WATER-BASED PAINT.
 - MATERIALS FOR PASSIVE TREE PROTECTION SHALL CONSIST OF HEAVY NYLON PLASTIC FLAGGING, A MINIMUM OF 4" (102.4 INCHES) WIDE WITH DARK LETTERS READING "TREE PROTECTION AREA - DO NOT ENTER OR EQUIVALENT SIGNAGE ON A CONTINUOUS, DURABLE RESTRAINT.
 - ALL TREE PROTECTION DEVICES MUST REMAIN IN FUNCTIONING CONDITION UNTIL THE COMPLETION OF THE PROJECT OR UNTIL THE CERTIFICATE OF OCCUPANCY IS ISSUED.
 - ANY TREE DESIGNATED ON THE PLAN TO BE SAVED, WHICH IS DAMAGED DURING CONSTRUCTION OR AS A RESULT OF CONSTRUCTION, AS DETERMINED BY THE ARBORIST, SHALL BE TREATED ACCORDING TO ACCEPTED NATIONAL ARBORIST ASSOCIATION STANDARDS, OR REPLACED WITH A TREE OF EQUAL OR GREATER VALUE TO THE TREE DAMAGED. HOWEVER, ANY SPECIALLY TREE DAMAGED AS DESCRIBED ABOVE SHALL BE REPLACED WITH TREES EQUAL TO 2 (TWO) TIMES THE UNIT VALUE OF THE TREE BEING REPLACED.
 - ANY PERSON, FIRM OR CORPORATION VIOLATING ANY PROVISIONS OF THIS ARTICLE SHALL BE FINISHED AS DESCRIBED IN SECTION 14-6 OF THE CODE OF THE CITY OF ROSWELL, AND IN ADDITION THEREIN MAY BE INJOINED FROM CONTINUING THE VIOLATION. EACH TREE CUT, DAMAGED OR POISONED SHALL CONSTITUTE A SEPARATE OFFENSE.

GENERAL NOTE:
EXISTING TREES TO BE SAVED ARE THOSE THAT ARE WITHIN THE TREE SAVED AREAS AND THE CRITICAL ROOT ZONES WILL NOT BE IMPACTED. HOWEVER, ALL TREES WITHIN THE TREE SAVED AREAS WILL REMAIN, BUT DO NOT COUNT TOWARD THE TREE DENSITY REQUIREMENTS.

IRRIGATION NOTE:
IRRIGATION SYSTEM SHALL BE PROVIDED BY CONTRACTOR AS AN AS BUILT SYSTEM.

DBH	Common Name	Quantity	Unit Value	Total Units
10"	Maple	1	3.6	3.6
12"	Maple	1	4.2	4.2
13"	Maple	2	4.5	9
15"	Maple	2	5.05	10.1
16"	Maple	1	5.3	5.3
17"	Maple	1	5.5	5.5
15"	Pear	1	4.5	4.5
16"	Pine	1	5.3	5.3
18"	Pine	1	5.7	5.7
12"	Sweetgum	2	4.2	8.4
16"	Walnut	1	5.3	5.3
9"	Willow Oak	1	3.3	3.3
11"	Willow Oak	1	3.9	3.9
13"	Willow Oak	2	4.5	9
14"	Willow Oak	2	4.8	9.6
19"	Willow Oak	1	5.85	5.85
21"	Willow Oak	1	6.15	6.15
22"	Willow Oak	1	6.3	6.3
23"	Willow Oak	1	6.45	6.45
24"	Willow Oak	2	6.6	13.2
Total Units				130.65

DBH	Common Name	Quantity	Unit Value	Total Units
10"	Maple	1	3.6	3.6
12"	Maple	1	4.2	4.2
15"	Maple	1	5.05	5.05
15"	Pear	1	4.5	4.5
12"	Sweetgum	2	4.2	8.4
16"	Walnut	1	5.3	5.3
9"	Willow Oak	1	3.3	3.3
11"	Willow Oak	1	3.9	3.9
13"	Willow Oak	2	4.5	9
14"	Willow Oak	2	4.8	9.6
Total Units				56.85

Tree Density Calculations for North Fulton Hospital

SITE DENSITY FACTOR (SDF)
SDF = Total Acreage x 30
SDF = 5.6 Acres x 30
SDF = 168 Units Required

EXISTING DENSITY FACTOR (EDF)
EDF = 73.8 Units

REPLACEMENT DENSITY FACTOR (RDF)
RDF = SDF - EDF
RDF = 168 - 73.8 RDF = 94.2 Units Required
RDF PROVIDED = 75.5 UNITS

RECOMPENSE REQUIRED = 0 UNITS
RECOMPENSE PROVIDED = 0 UNITS
TOTAL UNITS PROVIDED = 75.5 UNITS

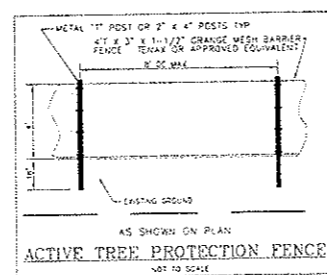
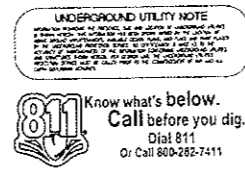

NOTE: EXISTING TREES IN TRACT 'A' WERE FIELD LOCATED BY ARBORIST AND NOT FIELD SURVEYED BY SURVEYOR.

APPLICANT/OWNER:
BREMNER DUKE NORTH FULTON DEVELOPMENT, LLC
CONTACT: JASON HINKEL
600 EAST 96th STREET
INDIANAPOLIS, INDIANA 46240

24 Hour Contact:
NEAL HOWARD
DUKE CONSTRUCTION LP
3950 Shackleford Rd
Suite 300
Duluth, GA 30096
(770) 638-2514

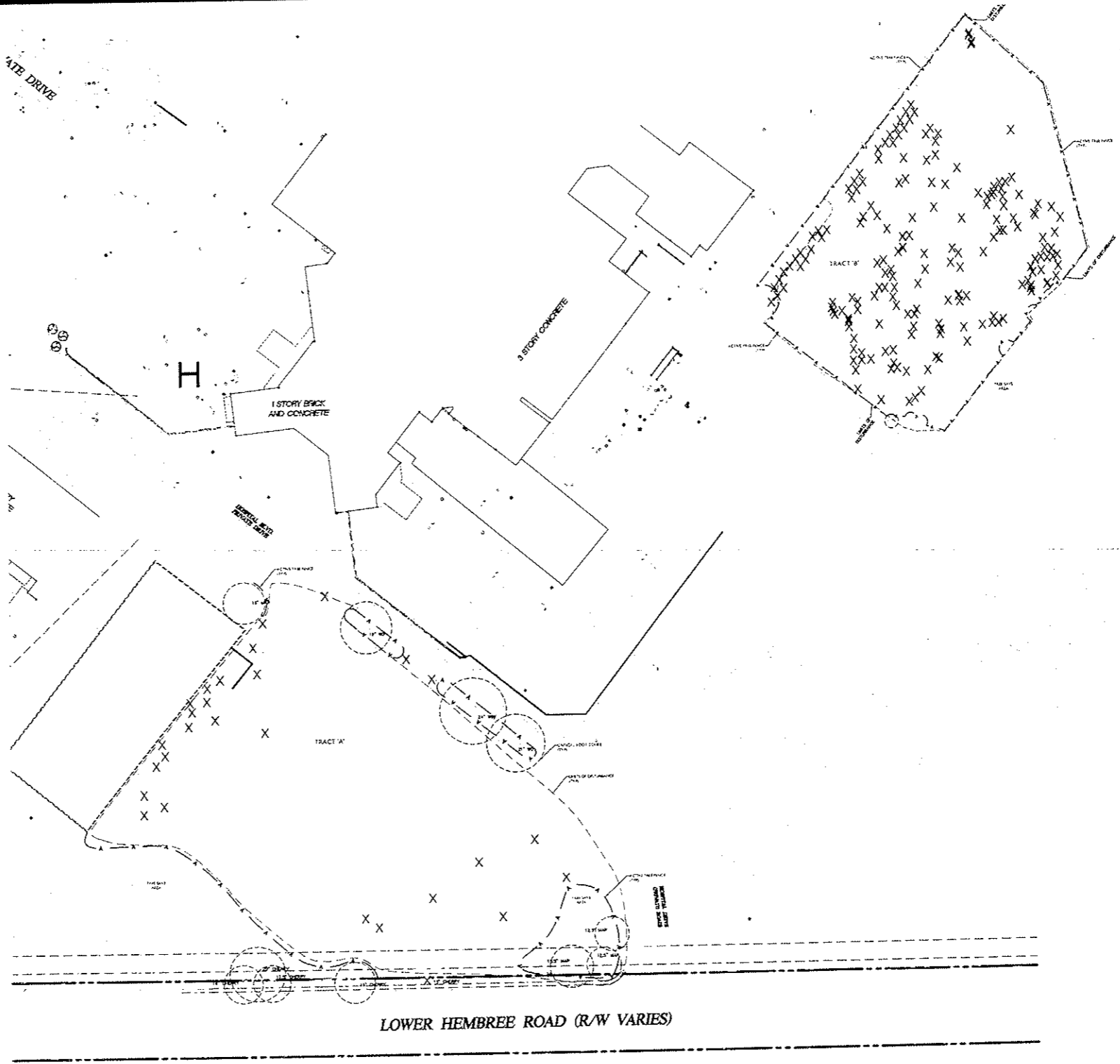
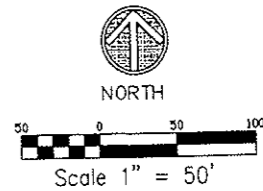

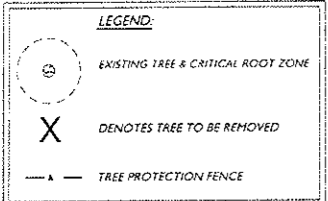

SITE DATA:
 TOTAL ACRES - 5.6
 TRACT 'A' - 3.4
 TRACT 'B' - 2.2
 LAND LOT 596
 1st DISTRICT, 2nd SECTION

- TREE ORDINANCE, CITY OF ROSWELL**
- THE ARBORIST SHALL MAKE UNSCHEDULED INSPECTIONS BEFORE AND DURING DEVELOPMENT TO ENSURE PROTECTION OF TREES, CRITICAL ROOT ZONES AND BUFFER ZONES.
 - NO PERSON IN THE CONSTRUCTION OF ANY STRUCTURES OR IMPROVEMENTS OR ANY ACTIVITY SHALL ENCOACH OR PLACE SOLVENTS, MATERIAL, CONSTRUCTION MACHINERY OR TEMPORARY SOIL DEPOSITS WITHIN 50' (5) FEET OF THE AREA OUTSIDE THE DROP LINE, AS DEFINED HEREIN, OF ANY SPECIAL TREE OR ANY TREE WITHIN A TREE PROTECTION ZONE.
 - BEFORE DEVELOPMENT, LAND CLEARING, FILLING, OR ANY LAND ALTERATION, THE DEVELOPER SHALL BE REQUIRED TO ERECT SUITABLE BARRIERS AS REQUIRED BY THE ARBORIST, INCLUDING TREE FENCES, TREE PROTECTION SIGNS, AND EROSION BARBERS UNTIL COMPLETION OF SITE LAYOUT PLANS. AUTHORIZATION TO REMOVE THE PROTECTIVE DEVICES SHALL BE IN WRITING BY THE ARBORIST OR BY THE ISSUANCE OF A FINAL CERTIFICATE OF OCCUPANCY. INSPECTION OF TREE PROTECTION BARRIERS IS REQUIRED PRIOR TO ANY LAND DISTURBANCE OR DEVELOPMENT. THE ARBORIST SHALL BE CONTACTED TO SCHEDULE AN INSPECTION TIME.
 - MATERIALS FOR ACTIVE TREE PROTECTION SHALL CONSIST OF CHAIN LINK OR ANGLE LAMINATED PLASTIC, WOODEN POST AND RAIL FENCING OR OTHER EQUIVALENT RESISTANT MATERIAL. IN ADDITION TO FENCING, WHERE ACTIVE TREE PROTECTION IS REQUIRED EACH TREE TO BE SAVED SHALL BE MARKED AT THE BASE OF THE TRUNK WITH BLACK COLORED WATER-BASED PAINT.
 - MATERIALS FOR PASSIVE TREE PROTECTION SHALL CONSIST OF HEAVY MIL. PLASTIC LEADING, A MINIMUM OF 4" (FOUR INCHES) WIDE WITH DARK LETTERS READING "TREE PROTECTION AREA - DO NOT ENTER" OR EQUIVALENT SIGNAGE ON A CONTINUOUS, DURABLE RESISTANT.
 - ALL TREE PROTECTION DEVICES MUST REMAIN IN FUNCTIONING CONDITION UNTIL THE COMPLETION OF THE PROJECT OR UNTIL THE CERTIFICATE OF OCCUPANCY IS ISSUED.
 - ANY TREE DESIGNATED ON THE PLAN TO BE SAVED, WHICH IS DAMAGED DURING CONSTRUCTION OR AS A RESULT OF CONSTRUCTION, AS DETERMINED BY THE ARBORIST, SHALL BE TREATED ACCORDING TO ANY APPLICABLE NATIONAL ARBORISTS ASSOCIATION STANDARDS, OR REPLACED WITH A TREE OF TREES EQUAL TO THE UNIT VALUE OF THE TREE REPLACED. HOWEVER, ANY SPECIALLY TREE DAMAGED AS DESCRIBED ABOVE SHALL BE REPLACED WITH TREES EQUAL TO 2 (TWO) TIMES THE UNIT VALUE OF THE TREE DAMAGED OR REPLACED.
 - ANY PERSON, FIRM OR CORPORATION VIOLATING ANY PROVISIONS OF THIS ARTICLE SHALL BE FINED AS DESCRIBED IN SECTION - 8 OF THE CODE OF THE CITY OF ROSWELL. AND IN ADDITION THERE TO MAY BE PROSECUTED FROM CONTINUING THE VIOLATION. EACH TREE CUT, DAMAGED OR FOLLOTTED SHALL CONSTITUTE A SEPARATE OFFENSE.

GENERAL NOTE:
 EXISTING TREES TO BE SAVED AND TREES THAT ARE WITHIN THE TREE SAVED AREAS AND THE CRITICAL ROOT ZONES WILL NOT BE IMPACTED. HOWEVER ALL TREES WITHIN THE TREE SAVED AREAS WILL REMAIN, BUT DO NOT COUNT TOWARDS SITE TREE DENSITY REQUIREMENTS.

IRRIGATION NOTE:
 IRRIGATION SYSTEM SHALL BE PROVIDED BY CONTRACTOR AS AN AS-BUILT SYSTEM.

DBH	Common Name	Quantity	Unit Value	Total Units
10"	Maple	1	3.6	3.6
12"	Maple	1	4.2	4.2
13"	Maple	2	4.5	9
15"	Maple	2	5.05	10.1
16"	Maple	1	5.3	5.3
17"	Maple	1	5.5	5.5
13"	Pear	1	4.5	4.5
16"	Pine	1	5.3	5.3
18"	Pine	1	5.7	5.7
12"	Sweetgum	2	4.2	8.4
16"	Walnut	1	5.3	5.3
9"	Willow Oak	1	3.3	3.3
11"	Willow Oak	1	3.9	3.9
13"	Willow Oak	2	4.5	9
14"	Willow Oak	2	4.8	9.6
15"	Willow Oak	1	5.85	5.85
21"	Willow Oak	1	6.15	6.15
22"	Willow Oak	1	6.3	6.3
23"	Willow Oak	1	6.45	6.45
24"	Willow Oak	2	6.6	13.2
Total Units				130.85

DBH	Common Name	Quantity	Unit Value	Total Units
10"	Maple	1	3.6	3.6
12"	Maple	1	4.2	4.2
13"	Maple	1	5.05	5.05
12"	Pear	1	4.5	4.5
12"	Sweetgum	2	4.2	8.4
11"	Walnut	1	5.3	5.3
9"	Willow Oak	1	3.3	3.3
11"	Willow Oak	1	3.9	3.9
13"	Willow Oak	2	4.5	9
14"	Willow Oak	2	4.8	9.6
Total Units				56.85

Tree Density Calculations for North Fulton Hospital

SITE DENSITY FACTOR (SDF)
 SDF = Total Acreage x 30
 SDF = 5.6 Acres X 30
 SDF = 168 Units Required

EXISTING DENSITY FACTOR (EDF)
 EDF = 73.8 Units

REPLACEMENT DENSITY FACTOR (RDF)
 RDF = SDF - EDF
 RDF = 168 - 73.8 RDF = 94.2 Units Required
 RDF PROVIDED = 75.5 UNITS

RECOMPENSE REQUIRED = 0 UNITS
 RECOMPENSE PROVIDED = 0 UNITS

TOTAL UNITS PROVIDED = 75.5 UNITS

UNDERGROUND UTILITY NOTE
 Know what's below. Call before you dig. Dial 811 or Call 605-282-7411

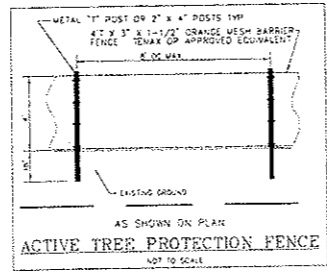

NOTE: EXISTING TREES IN TRACT 'A' WERE FIELD LOCATED BY ARBORIST AND NOT FIELD SURVEYED BY SURVEYOR.

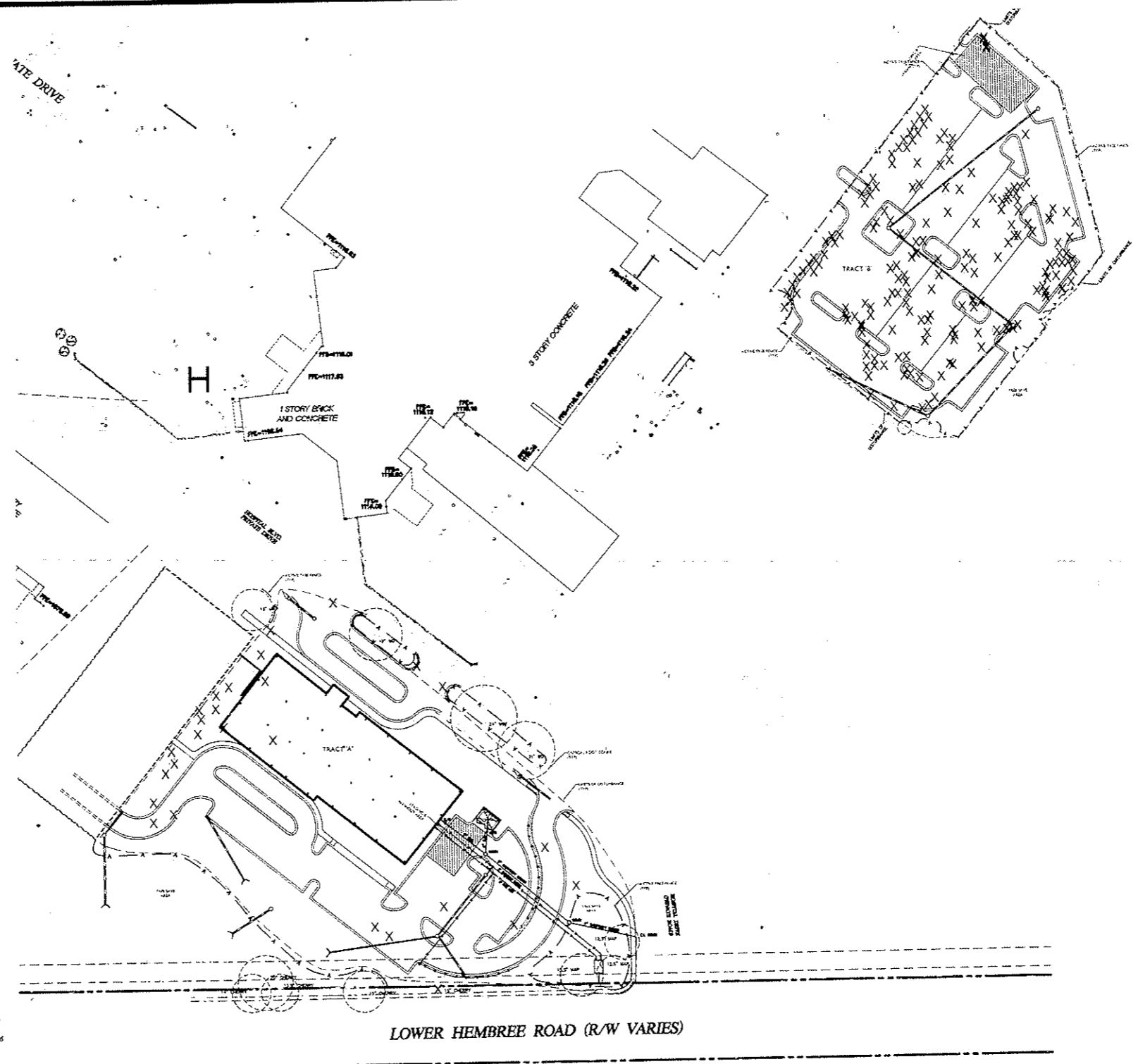

APPLICANT/OWNER:
 BREMNER DUKE NORTH FULTON DEVELOPMENT, LLC
 CONTACT: JASON HINKEL
 600 EAST 96th STREET
 INDIANAPOLIS, INDIANA 46240

24 Hour Contact:
 NEAL HOWARD
 DUKE CONSTRUCTION LP
 3950 Shiloh Road
 Suite 300
 Duluth, GA 30096
 (770) 438-2514

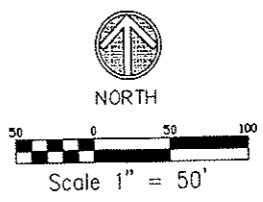

NORTH FULTON MEDICAL OFFICE BUILDING
 NORTH FULTON REGIONAL HOSPITAL
 HEMBREE ROAD & HIGHWAY 9
 CITY OF ROSWELL, FULTON COUNTY, GEORGIA
 OVERALL TREE PROTECTION PLAN

Scale By: _____
 Drawing Number: **LO2.0**
 Date Rec'd Job Number: 468740-020
 A/E Job Number: 10-1038-10

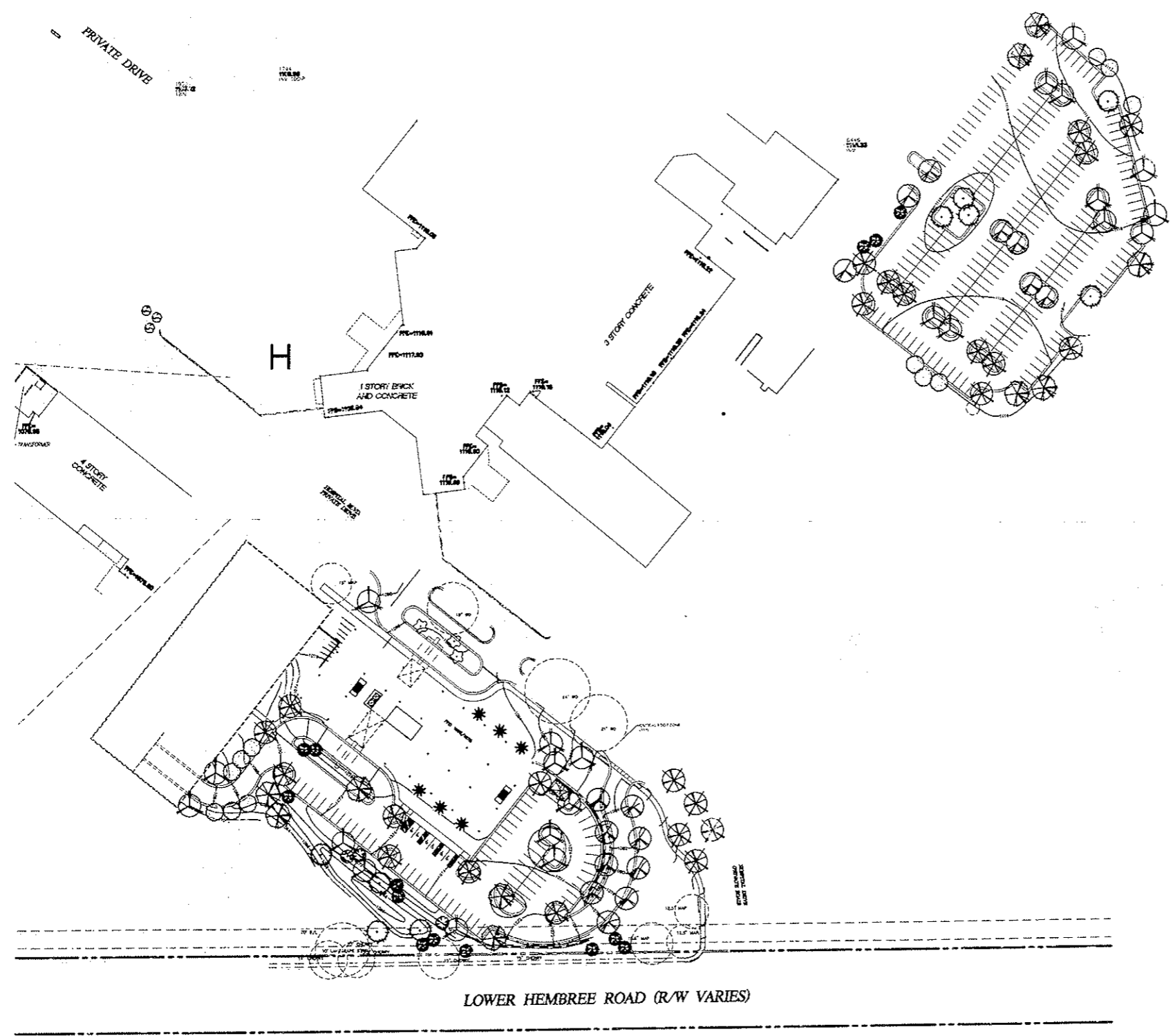

SITE DATA:
 TOTAL ACRES - 5.6
 TRACT 'A' - 3.4
 TRACT 'B' - 2.2
 LAND LOT 596
 1st DISTRICT, 2nd SECTION

- PROPOSED TREE LEGEND:**
- CRAPE MYRTLE
 - REDBUD
 - DOGWOOD
 - ZELKOVA
 - RED MAPLE
 - BLACK GUM
 - EUROPEAN HORNBEAM FASTIGIATA*
 - SOUTHERN MAGNOLIA
 - BALD CYPRESS
 - LACEBARK ELM

Duke
 CONSULTING
 2502 Peachtree Road
 Suite 400
 Atlanta, GA 30309
 Phone: (770) 742-1900
 Fax: (770) 742-2110

A/E/C
 55 West Springs Circle
 Roswell, Georgia 30075
 (770) 412-1000

Scale: 1" = 50'
 Date: JULY 10
 Drawn by: SLR, JCV
 Checked by: SLR

NORTH FULTON MEDICAL OFFICE BUILDING
NORTH FULTON REGIONAL HOSPITAL
 HEMBREE ROAD & HIGHWAY 9
 CITY OF ROSWELL, FULTON COUNTY, GEORGIA
OVERALL TREE REPLACEMENT PLAN

APPLICANT/OWNER:
 BREMNER DUKE NORTH FULTON
 DEVELOPMENT, LLC
 CONTACT: JASON HINKEL
 600 EAST 96th STREET
 INDIANAPOLIS, INDIANA 46240

24 Hour Contact
 NEAL HOWARD
 DUKE CONSTRUCTION LP
 1950 Shalston Rd
 Suite 300
 Duluth, GA 30096
 (770) 638-2514



Scale 1" = 50'

Label	Botanical Name	Common Name	DBH	Quantity	Unit Value	Total Units
ZEL	Zelkova serrata	Japanese Zelkova	4" cal	16	0.9	14.4
BG	Nyssa sylvatica	Black Gum	3" cal	23	0.5	11
MAP	Acer rubrum 'October Glory'	'October Glory' Red Maple	3" cal	10	0.5	5
BC	Taxodium distichum	Bald Cypress	3" cal	9	0.5	4.5
HB	Carpinus betulus	European Hornbeam 'Fastigiata'	3" cal	6	0.5	3
MAG	Magnolia grandiflora 'Bracken Brown Beauty'	'Bracken Brown Beauty' Magnolia	3" cal	12	0.5	6
LEE	Ulmus parvifolia	Lacebark Elm	4" cal	24	0.9	21.6
RED	Cercis canadensis	Redbud	2" cal	14	0.5	7
DOG	Cornus florida	Dogwood	2" cal	3	0.5	1.5
CM	Lagerstroemia indica 'Muskogee'	'Muskogee' Crape Myrtle	2" cal	3	0.5	1.5
Total Units						75.5

Tree Density Calculations for North Fulton Hospital
 SITE DENSITY FACTOR (SDF)
 SDF = Total Acres x 30
 SDF = 5.6 Acres X 30
 SDF = 168 Units Required
 EXISTING DENSITY FACTOR (EDF)
 EDF = 73.8 Units
 REPLACEMENT DENSITY FACTOR (RDF)
 RDF = SDF - EDF
 RDF = 168 - 73.8 RDF = 94.2 Units Required
 RDF PROVIDED = 75.5 UNITS
 RECOMPENSE REQUIRED = 0 UNITS
 RECOMPENSE PROVIDED = 0 UNITS
 TOTAL UNITS PROVIDED = 75.5 UNITS

GENERAL NOTE:
 EXISTING TREES TO BE SAVED ARE TREES THAT ARE WITHIN THE TREE SAVED AREAS AND THE CRITICAL ROOT ZONES WILL NOT BE IMPACTED. HOWEVER ALL TREES WITHIN THE TREE SAVED AREAS WILL REMAIN BUT DO NOT COUNT TOWARDS SITE TREE DENSITY REQUIREMENTS.

IRRIGATION NOTE:
 IRRIGATION SYSTEM SHALL BE PROVIDED BY CONTRACTOR AS AN AS-BUILT SYSTEM.

UNDERGROUND UTILITY NOTE
 Utility lines are shown in red on this plan. Call before you dig. Dial 811 or Call 800-282-7411

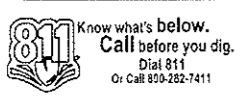

Stamp By: _____
 Drawing Number: **L03.0**
 State Reg. No. Number: N08FAU-03C
 A/E Job Number: 10-2038-10

SITE DATA:
 TOTAL ACRES TRACT 'A' - 3.4
 LAND LOT S96
 1st DISTRICT, 2nd SECTION

PROPOSED TREE LEGEND:

- CRAPE MYRTLE
- REDBUD
- DOGWOOD
- ZELKOVA
- RED MAPLE
- BLACK GUM
- EUROPEAN HORNBEAM 'FASTIGIATA'
- SOUTHERN MAGNOLIA
- BALD CYPRESS
- LACEBARK ELM

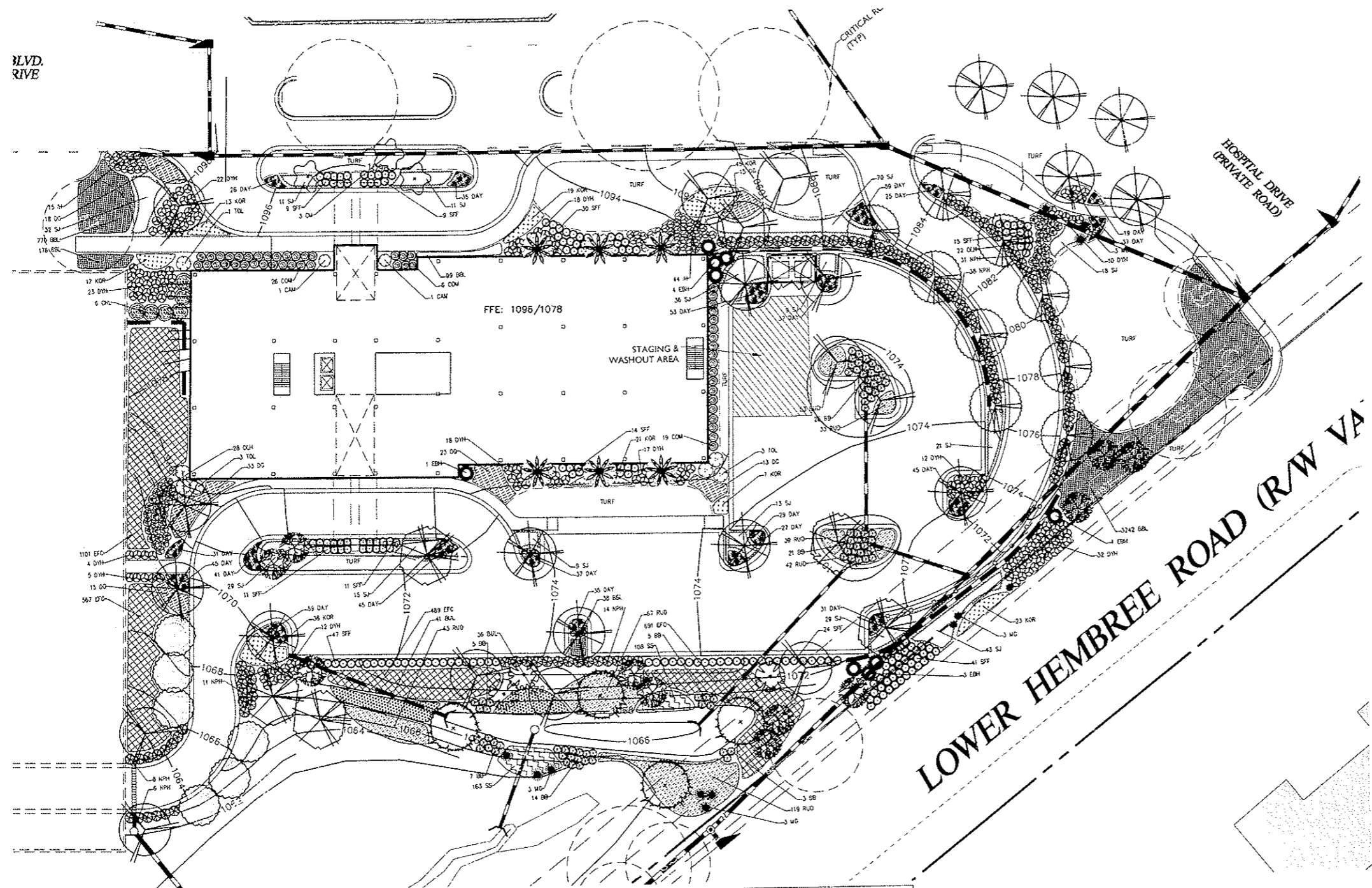

Plant Legend for Tract 'A' - North Fulton Hospital

Quantity	Label	Botanical Name	Common Name	Size	Spacing	Specifications
1	EBH	Emory Oak	Emory Oak	14" x 14"	As shown	fully installed
3	CM	Campanula medium	Campanula	12" x 12"	As shown	fully installed
7	TOL	Thalictrum flavum	Thalictrum	14" x 14"	As shown	fully installed
Shrubs						
111	IFH	Ipomoea pes-caprae	Ipomoea	1 gal	As shown	
4	CM	Campanula medium	Campanula	1 gal	As shown	
3	CMH	Campanula medium	Campanula	1 gal	As shown	
11	COM	Compositae	Compositae	1 gal	As shown	
108	NPH	Nepenthes	Nepenthes	1 gal	As shown	
172	DTH	Dioscorea	Dioscorea	1 gal	As shown	
184	KOR	Koeleria	Koeleria	1 gal	As shown	
150	GRU	Grasses	Grasses	1 gal	As shown	
150	GRU	Grasses	Grasses	1 gal	As shown	
117	DC	Dianthus	Dianthus	1 gal	As shown	
1	MG	Miscanthus	Miscanthus	1 gal	As shown	
141	S	Saxifraga	Saxifraga	1 gal	As shown	
Groundcover						
316	DAY	Daylily	Daylily	1 gal	2' x 2'	
1818	EPC	Euphorbia	Euphorbia	1" x 1"	24" x 24"	
4332	EBL	Elymus	Elymus	1" x 1"	18" x 18"	
Bioretention Plants						
115	IB	Ipomoea	Ipomoea	1 gal	As shown	
194	ALD	Albizia	Albizia	1 gal	2' x 2'	
211	SI	Sida	Sida	1 gal	2' x 2'	
27	BLA	Blackberry	Blackberry	1" x 1"	24" x 24"	
1160	EPC	Euphorbia	Euphorbia	1" x 1"	24" x 24"	
8	MG	Miscanthus	Miscanthus	1 gal	As shown	

UNDERGROUND UTILITY NOTE
 A utility search was conducted on 07/10/10. No underground utilities were located within the proposed construction area. The utility search was conducted in accordance with the City of Roswell, Georgia, Ordinance 10-2009-001.

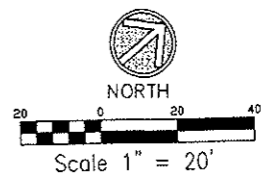
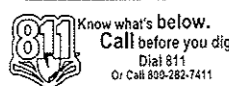

NORTH FULTON MEDICAL OFFICE BUILDING
NORTH FULTON REGIONAL HOSPITAL
 HEMBREE ROAD & HIGHWAY 9
 CITY OF ROSWELL, FULTON COUNTY, GEORGIA

LANDSCAPE PLAN - TRACT 'A'

Drawn By: _____
 Drawing Number: **L04.0**
 Date Revis: 08/10/10
 A/E Job Number: 10-3038-10

TREE ORDINANCE NOTES (CITY OF ROSWELL):

- The arborist shall make unscheduled inspections before and during development to ensure protection of trees, critical root zones and buffer zones.
- No person in the construction of any structure(s) or improvement(s) or any agency shall encroach or place solemens, material, construction machinery or temporary soil deposits within six (6) feet of the area outside the emp line, as defined herein, of any specimen tree or any tree within a tree protection zone.
- Before development, land clearing, filling, or any land alteration, the developer shall be required to erect suitable barriers as required by the arborist, including tree fences, tree protection signs, and erosion barriers until completion of site landscaping. Authorization to remove the protective devices shall be in writing by the arborist or by the issuance of a final certificate of occupancy. Inspection of tree protection barriers is required prior to any land disturbance or development. The arborist shall be contacted to schedule an inspection date.
- Materials for active tree protection shall consist of chain link, orange laminated plastic, wooden post and rail fencing or other equivalent restraining material. In addition to fencing, where active tree protection is required, each tree to be saved shall be marked at the base of the trunk with blue colored water-based paint.
- Materials for passive tree protection shall consist of heavy mil plastic flagging, a minimum of 4" (four inches) wide with dark letters reading "TREE PROTECTION AREA - DO NOT ENTER" or equivalent signage on a continuous, durable restraint.
- All tree protection devices must remain in functioning condition until the completion of the project or until the Certificate of Occupancy is issued.
- Any tree designated on the plan to be saved, which is damaged during construction or as a result of construction, as determined by the arborist, shall be reared according to accepted national arborist association standards, or replaced with a tree or trees equal to the unit value of the tree removed. However, any specimen tree damaged as described above shall be replaced with trees equal to 2 (two) times the unit value of the tree removed or damaged.
- Any person, firm or corporation violating any provision of this article shall be punished as described in section 1-8 of the code of the City of Roswell, and in addition thereto may be enjoined from continuing the violation. Each tree cut, damaged or poisoned shall constitute a separate offense.

GENERAL NOTES:

- Prior to construction, the landscape contractor shall be responsible for locating all underground utilities and shall avoid damage to all utilities during the course of the work. The landscape contractor is responsible for repairing any and all damage to utilities, structures, site appearances, etc., which occurs as a result of the landscape construction.
- The landscape contractor is responsible for accurate plant counts prior to pricing of trees, shrubs, perennials, annuals, groundcovers, sod, seed and pine straw.
- Quantities are given for convenience only. The landscape contractor shall verify plant counts from plan, and shall provide and install all plant material shown on the plan.
- All plant material chosen must be free of disease and pests, be of good quality, well-shaped and branched.
- All trees in lawn area to have a 4" diameter mulch bed.
- No planting bed edge shall be closer than 21" from the back of curb or sidewalk.
- Planting bed lines, trees, shrubs, groundcovers, and seasonal color placement shall be approved by the project landscape architect or owner's representative prior to installation.
- The landscape contractor shall be responsible for providing positive drainage at 2% minimum in all planted areas.
- O.C. = on center, and S.A.S. = Space as shown.
- All plants must be container-grown or balled and burlapped (B&B), as indicated in the plant list.
- All trees must be straight trunked, full headed and meet all requirements as specified.
- All plants are subject to the approval of the landscape architect and the owner, before, during and after installation.
- All trees must be guyed or staked as shown in the detail.
- All plants and planting areas must be completely mulched as specified.
- Pine straw beds are to be mulched with 4" of pine straw. All beds are to be mulched immediately after planting.
- The landscape contractor is responsible for fully maintaining all plantings (including, but not limited to: watering, spraying, mulching, fertilizing, etc.) until the work is accepted in total by the landscape architect and the owner.
- The landscape contractor shall completely guarantee all plant material for a period of one (1) year, beginning at the date of final acceptance. The landscape contractor shall promptly make all replacements before the end of the guarantee period (as per direction of the owner).
- The owner agrees to perform all landscape maintenance (including watering) throughout the one year guarantee period unless otherwise determined.
- The landscape architect will approve the staked location of all plant material prior to installation.
- After being dug at the nursery source, all trees in fact shall be acclimated for two (2) weeks under a mist system prior to installation.
- Any plant material which dies, turns brown or defoliates (prior to total acceptance of the work), shall be promptly removed from the site and replaced with material of the same species, quantity, size and meeting all plant list specifications.
- Standards set forth in "American Standards for Nursery Stock" represent guideline specifications only and constitute minimum quality requirements for plant material.

SEASONAL COLOR PLANTING NOTES:

- Excavate seasonal color bed to a depth of 4". Remove existing soil from site. Break through "hardpan" and remove all stone, roots, debris, etc. Relevel excavated bed and additional 6-8" depth.
- Slope the base of the seasonal color bed to the trench edge.
- Prepare planting soil mix consisting of topsoil and the following soil amendments per 100 s.f.:
400 lbs. of composted cow manure
45 c.t. of humus
500 lbs. of peat moss
5 lbs. of lime (adjust for alkaline soils)
- Add 6" of planting soil to excavated bed and relevel into existing soil.
- Place additional planting soil mix to raise entire bed 3" above finished grade. If seasonal bed fronts a shrub or groundcover bed, match this bed's height (4" above finished grade) and continue positive slope toward trench edge.
- Roskill entire bed to a depth of 10-12"
- Evenly spread fertilizer appropriate to variety of seasonal color at a maximum rate of 2.5 lbs. per 100 s.f. and rake into top 3" of soil.
- Plant seasonal color as specified and at indicated spacing shown on plans.
- Edge seasonal color bed and mulch with small pine bark nuggets (1" max).
- Water thoroughly.

KUDZU REMOVAL:

- FOLIAR APPLICATIONS CAN BE MADE FROM LATE JUNE THROUGH EARLY OCTOBER. GIVE KUDZU PLENTY OF TIME TO LEAF OUT BEFORE APPLYING A FOLIAR APPLICATION. STUDIES SUGGEST THE BEST TIME TO MAKE FOLIAR APPLICATIONS IS WHEN KUDZU IS BLOOMING (JULY, AUGUST, SEPTEMBER).
- KUDZU GROWING ALONG THE GROUND AND OVER LOW OBJECTS: A FOLIAR SPRAY APPLICATION IS MADE USING A PRODUCT WITH THE ACTIVE INGREDIENT CLORPYRIFOS SUCH AS "LONTREL (R) TURF AND ORNAMENTAL SPECIALTY HERBICIDE" AND "TRANSLINE".
- KUDZU GROWING OVER TALL TREES: KUDZU VINES THAT ARE GROWING INTO OR OVER TALL TREES ARE FIRST SEVERED AS CLOSE TO GROUND LEVEL AS POSSIBLE (SHEARS AND PRUNING SAWS WORK WELL ON YOUNG OR SPARSE STANDS AND GAS POWERED POLE SAWS AND BRUSH CUTTERS WORK WELL ON MATURE OR THICK STANDS). AN HERBICIDE LABELED FOR APPLYING TO THE CUT KUDZU STEMS IS THEN APPLIED AS QUICKLY AS POSSIBLE AFTER THE KUDZU VINE IS SEVERED (CUT STEM METHOD). A SPRAY BOTTLE WILL WORK WELL FOR APPLYING HERBICIDES TO THE CUT STEM. PRODUCTS WITH THE ACTIVE INGREDIENT TRICLOPYR SUCH AS "GARLON 34" AND "BRUSH BE GONE CONCENTRATE" ARE RECOMMENDED FOR THIS USE (BRUSH BE GONE CONCENTRATE IS AVAILABLE FOR HOMEOWNERS IN SMALL QUANTITIES AT MANY GARDEN CENTERS).

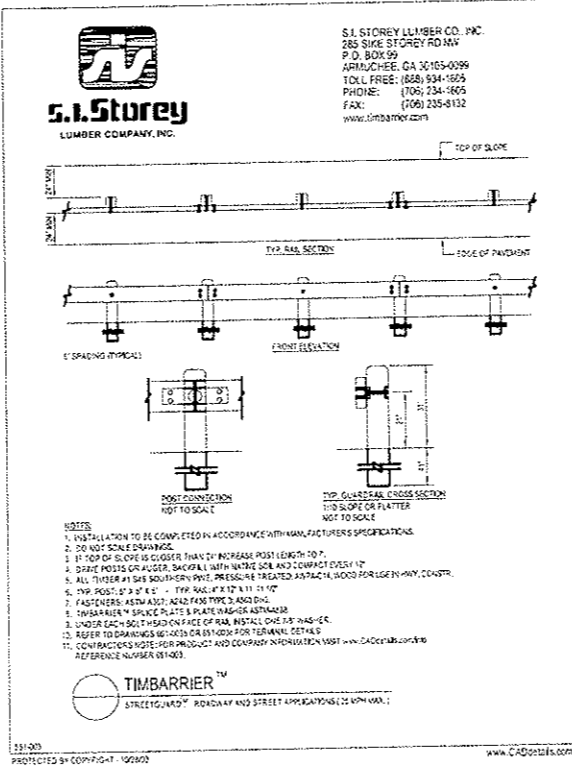
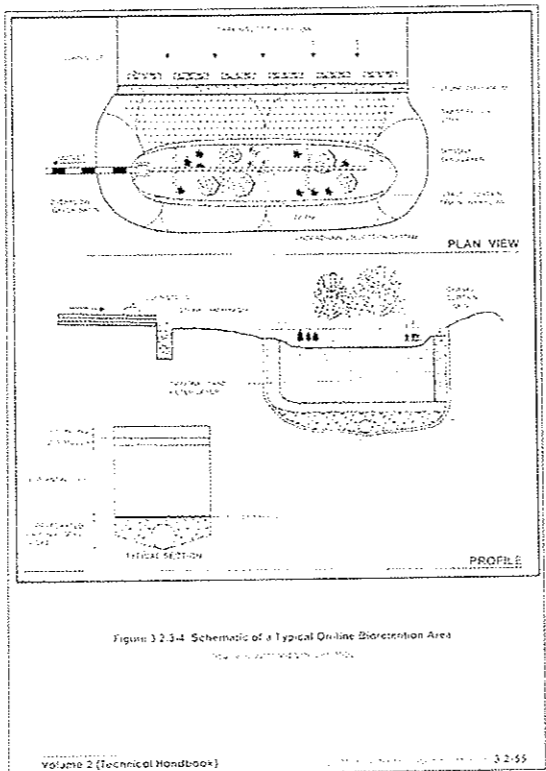
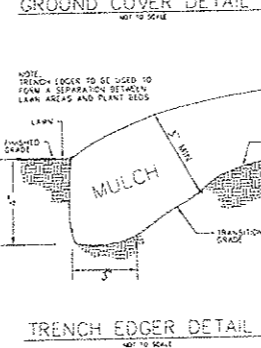
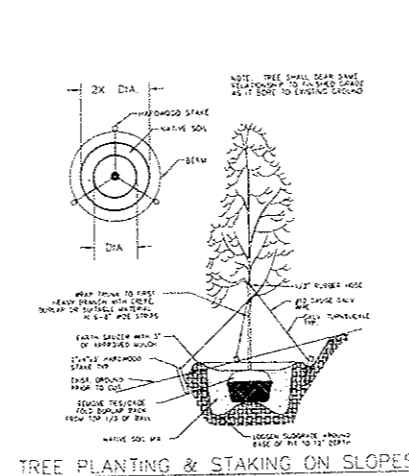
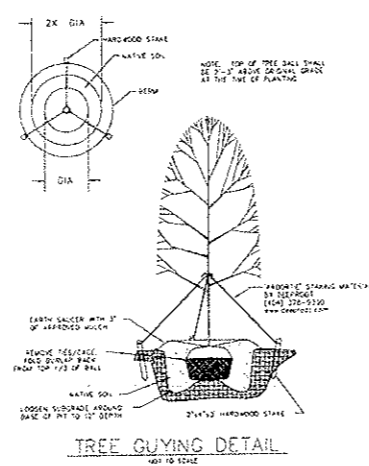
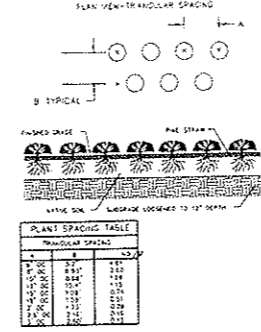
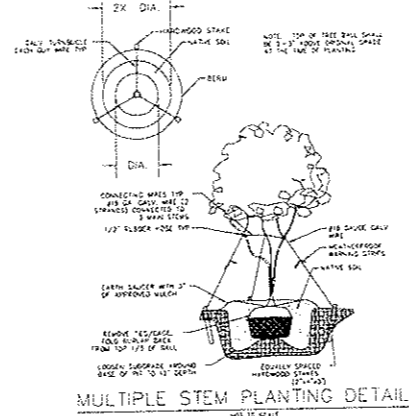
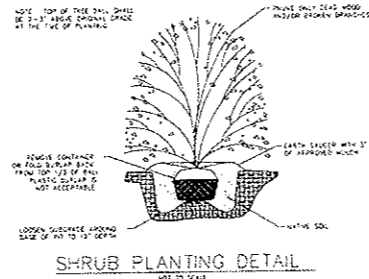

SITE DATA:
TOTAL ACRES - 5.6
TRACT 'A' - 3.4
TRACT 'B' - 2.2
LAND LOT 596
1st DISTRICT, 2nd SECTION

APPLICANT/OWNER:
BREMNER DUKE NORTH FULTON
DEVELOPMENT, LLC
CONTACT: JASON HINKEL
600 EAST 96th STREET
INDIANAPOLIS, INDIANA 46240

UNDERGROUND UTILITY NOTE
Know what's below.
Call before you dig.
Dial 811
or Call 800-282-7411



55 Wayne Street
P.O. Box 1000
Columbus, GA 31906
(706) 325-1000
www.aeg.com

NORTH FULTON MEDICAL OFFICE BUILDING
NORTH FULTON REGIONAL HOSPITAL
HEMBREE ROAD & HIGHWAY 9
CITY OF ROSWELL, FULTON COUNTY, GEORGIA
TREE PROTECTION NOTES & DETAILS

Scale: 1/8" = 1'-0"

Drawn By: [Blank]

Check Number: L05.0

Drawn By: [Blank]

Scale: 1/8" = 1'-0"